

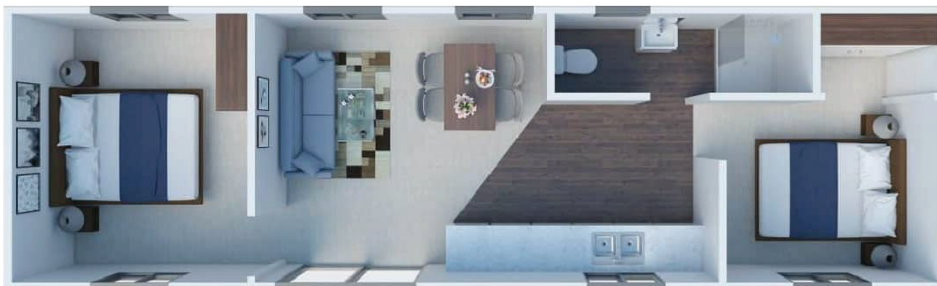

Tiny House

12m x 3.6m / 43.2m²
2 bedrooms



The 2 Brm Tiny House from Unit2Go is constructed from shadow clad ply on the outside with insulated timber frame walls with cavity and grooved MDF on inside. It comes fully painted with coloursteel roof, timber floor with steel support bearers.

Cash price
\$129,995

Finance for 10 years
\$464 p/w*

Finance for 8 years
\$517 p/w*

*See details below



Council Code of Compliance

All units are built by a Licensed Building Practitioner and come with a CCC (ex factory).



10 Year Warranty

As the law requires, all our units come with a minimum 10 year watertightness and structural warranty.



Vented Cavity

All units come with a vented cavity for improved water-tightness and durability



Fully Insured

All our units are fully insured during build, during delivery and with their CCC can be insured ongoing by you the buyer.

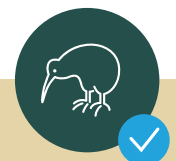

Kiwi Made

All units have traditional NZ timber framing, Kiwi joinery, roofing, cladding and lining as you would expect in any good quality home.

Tiny House

12m x 3.6m / 43.2m²
2 bedrooms

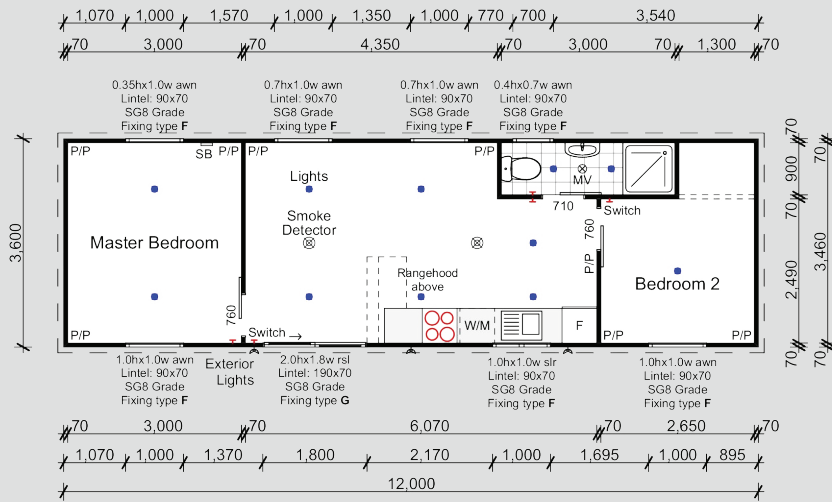

Standard kitchen

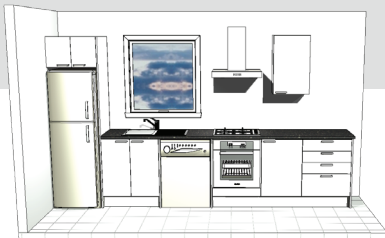

Upgraded kitchen



Standard colours

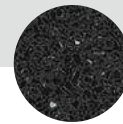

Benchtop
Sonora Black

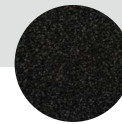

Carpet
Fairview



Vinyl flooring
533

What's included

- Transportable Cabin
- Double glazing RO .37
- Two bedrooms
- Separate living
- Kitchenette
- Ensuite bathroom
- Toilet, shower, vanity
- Gas Califont Hot Water
- Splash back
- Front ranch-slider door
- A small rear window in the bathroom
- 3x windows in the living area
- 2x windows in the master bedroom
- 1x window in the second bedroom
- Double power points
- Led lights (interior and exterior)
- Smoke detection

Optional extras

Extra TV or power points, French Doors / Stacker Sliders, Saniflo Wastewater System, Electric / Gas Oven, Rangehood, Upright pantry, Extra decking / steps, Heat pump, Breakfast bar, Dishwasher, Washing machine

Pricing and Finance details

Cash price	Weekly payment	Loan term & interest rate	Minimum deposit
\$129,995	\$464.00	10 years at 14.90%	\$4,000
	\$517.00	8 years at 14.90%	\$4,000

Important Information

- All prices include GST.
- All units come with kitchen and bathroom, except Sleep Out 4.1 x 2.4m. For specifications of each unit, visit unit2go.co.nz.
- All prices are ex-factory meaning delivery costs of the unit are not included. Delivery starts at \$1,150 and increases depending on the size of the unit and distance from Auckland. Contact Unit2Go for an estimate of the likely cost. Delivery costs and the minimum deposit must be paid up front.
- The Loan Establishment Fee is \$480. The weekly payments shown above have been worked out on the basis that this fee is financed. This fee can be paid separately by you.
- All weekly payments include a documentation fee of \$450.
- Interest rate quoted is fixed annual rate for the term of the loan.
- The finance is offered by UFinance Limited. If you wish to finance the unit you will need to complete UFinance's application and are subject to UFinance credit and lending criteria. See ufinance.co.nz for full terms and conditions.



New Zealand Made
license nr: 803176



Licensed Building
Practitioner